

# HOOSIER SURVEYOR

QUARTERLY PUBLICATION OF THE  
INDIANA SOCIETY OF  
PROFESSIONAL LAND SURVEYORS, INC.

VOLUME 18  
NUMBER 4  
SPRING 1992



AFFILIATED WITH THE  
AMERICAN CONGRESS ON  
SURVEYING & MAPPING



## ISPLS SPONSORS WORKSHOPS ON SURVEYING STANDARDS



ISPLS members Wesley Day, left, and Gary Kent, right, have presented seminars and are dedicated to upgrading land surveying standards in Indiana.

# Introducing Indianapolis' newest, most complete source for surveying equipment and supplies.

## Your one-stop headquarters for:

- Levels
- Construction Lasers
- Cable or Magnetic Locators
- Total Stations
- Theodolites & Transits
- Survey & CAD Software
- Plotters
- Portable Radios
- Field Supplies & Accessories
- Repair & Calibration

## Authorized dealer:

**Leica**

David White Instruments

**AGL**

Schonstedt

**KOH-I-NOOR**

**Radius**  
A DIVISION OF MOTOROLA, INC.

**SALES • SERVICE • RENTAL • LEASING**



# SEILER INSTRUMENT

1-800-444-7952

**LOOK FOR OUR NEW INDIANAPOLIS OFFICE  
OPENING SOON!**

### 1992 OFFICERS AND DIRECTORS

Randolph Sexton - President  
419 North State Street  
Kendallville, IN 46755  
219 347-4345 Home  
219 347-4345 Office

Herendeen - President/Elect  
Buttercup Drive  
Westfield, IN 46183  
317 861-6298 Home  
317 573-4615 Office

E. Donald Bengel - Vice President  
703 Division Road  
Valparaiso, IN 46383  
219 465-0988 Home  
219 462-0690 Office

David Blankenkemper - Secretary  
422 Meigs Avenue  
Jeffersonville, IN 47130  
812 283-4060 Home  
812 282-4183 Office

E.R. Gray, III - Treasurer  
P.O. Box 1357  
Columbus, IN 47202  
812 546-5193 Home  
812 379-1525 Office

### TERM EXPIRES JAN/1993

Tom Boofter  
521 Bentbrook Drive  
New Albany, IN 47150  
812 944-1603 Home  
812 944-8222 Office

Ross Holloway  
P.O. Box 234  
Mooreville, IN 46158  
317 831-4094 Home  
317 248-5049 Office

### E.R. Gray, III - Secretary

James Dankert  
7172 Graham Road  
Indianapolis, IN 46250  
317 877-2227 Home  
317 842-6777 Office

### TERM EXPIRES JAN/1994

Brenda Owens  
8279 Castle Ridge Lane  
Indianapolis, IN 46256  
-0403 Home  
1-8510 Office

### Randolph Sexton - President

Pat Cunningham  
309 Columbia St. STE 101  
Lafayette, IN 47901  
317 567-4323 Home  
317 742-6479 Office

Rich Hudson  
574 North 50 West  
Valparaiso, IN 46383  
219 462-2946 Home  
219 462-1158 Office

### TERM EXPIRES JAN/1995

### E. Donald Bengel - Vice President

Chris Marbach  
55308 Jay Dee Street  
Elkhart, IN 46514  
616 699-5224 Home  
219 293-3611 Office

### David Blankenkemper - Secretary

### Douglas Herendeen - President/Elect

**ADMINISTRATIVE OFFICE**  
Dianne S. Bennett, Admin./Sec.  
55 Monument Circle, Suite 1222  
Indianapolis, IN 46204  
317 687-8859

### EDITOR'S NOTE

Deadlines for copy for various planned issues of the Hoosier Surveyor are as follows: Winter issue-December 31; Spring issue-March 31; Summer issue June 30; Fall issue-September 30.

The Hoosier Surveyor is published quarterly by the Indiana Society of Professional Land Surveyors, to inform land surveyors and related professions, government officials, educational institutions, libraries, contractors, suppliers, and associated businesses and industries about land surveying affairs.

and columns appearing in this publication do not necessarily reflect the views of ISPLS or the Hoosier Surveyors staff, but are published as a service to its members, the general public and for the betterment of the surveying profession. No responsibility is assumed for errors, misquotes or omissions as to its contents.

Editorial Advertising Offices  
55 Monument Circle, Suite 1222  
Indianapolis, IN 46204  
(317) 687-8859

Ken Curtis - Editor  
317 494-2165 Office  
317 463-7452 Home

Mike Crawford - Assistant Editor  
317 872-8400 Office  
317 842-5814 Home

ISPLS is a Non-Profit Organization

# HOOSIER SURVEYOR

VOLUME 18 NUMBER 4 SPRING 1992

## CONTENTS

Masthead	1
President's Thoughts	2
State Board of Registration	3-4
Minutes BOD Meeting/Focus on the Future	5
Standards Workshops/Standards History	7
Open Letter to ISPLS Members	8
Minuteman Questionnaire	9
Address to ACSM	10-11
Professional Development Program	13-15
NSPS Governors Report	17-19
Draft Surveyors Creed & Cannons	21
Chapters/County Surveyor	22
Completed Careers/Historical Society	23
Calendar/Sustaining Members/Classified	24

## Committee Assignments (1992)

### STANDING COMMITTEES

#### BY-LAWS

Ron Hansell - Chairman  
John Beals  
Donald Bengel

#### CHAPTERS

David Blankenkemper - Chairman  
Rick Miller  
President Central Indiana Chapter  
Chuck Coyle  
President Hoosier Hills Chapter  
Tom Boofter  
President Initial Point Chapter  
Mike Gerberick  
President Northwest Chapter  
Ken Jones  
President St. Joe Chapter  
Mike Nagel  
President Northeast Chapter  
Matt Wannemuehler  
President Southwest Chapter

#### CONVENTION COORDINATING

Doug Herendeen - Chairman  
Orwic Johnson  
Anthony Krue, Jr.  
Victor McCauley  
Terry Miller  
Dan Pusey

#### EDUCATION

Ross Holloway - Chairman  
Anthony Gregory  
Dean Hamilton  
John Porter  
Gordon Richardson  
Edward Sweetland

#### ETHICS

John Schneider - Chairman  
Ross Holloway  
Danny Leek  
Chris Marbach

#### FINANCE

E.R. Gray, III - Chairman  
Jake Hall

#### GOVERNMENT AFFAIRS

Gary Kent - Chairman  
Pat Cunningham  
Jake Hall  
Randy Sexton  
Roger Woodfill

#### HEADQUARTERS

Randy Sexton  
Doug Herendeen  
Don Bengel  
David Blankenkemper  
E.R. Gray, III

### HOOSIER SURVEYOR

Ken Curtis - Editor  
Mike Crawford - Assistant Editor  
Roger Woodfill

#### LIBRARY

Pete Arnold - Chairman  
Ken Curtis  
David Best

#### MEMBERSHIP

John Silnes - Chairman  
Joe Blevis  
Tom Daugherty  
Larry Manning  
Rick Miller  
John Porter

#### NOMINATIONS

Gary Kent - Chairman  
Don Bengel  
Rollyn Blankenkemper

#### PUBLIC RELATIONS

Perry Cloyd - Chairman  
Roger Fine  
Orwic Johnson  
Anthony Krue, Jr.  
Victor McCauley  
Dan Pusey  
Les Weber

#### PUBLICATIONS

Jerry Carter - Chairman  
David Blankenkemper  
Norm Hiselman  
Herschel Manhart  
John Silnes

#### SCHOLARSHIP

Orwic Johnson - Co-Chairman  
Dale Grimes - Co-Chairman  
Lee Bender  
Jim Dankert  
Bryan Foust  
Dean Hamilton  
Mark Isaacs  
Danny Leek  
David Pilz

#### STANDARDS

Wes Day - Chairman  
Edwin Boyd  
Pat Cunningham  
Gary Kent  
Chris Marbach  
Rich Hudson

#### AD HOC COMMITTEE

**COLLEGIATE/IUPUI SURVEYING  
COURSE STUDY**  
Pat Cunningham - Chairman

### Collegiate/IUPUI Surveying Course Study Continued

Roger Fine  
Art Haase  
Scott Zeigler

### PROFESSIONAL DEVELOPMENT EVALUATION

Anthony Gregory - Chairman  
Rich Hudson  
Dave Pilz  
Gordon Richardson

### SOCIETY LIAISON

### COUNTY SURVEYORS ASSOC.

Don Bengel - Chairman  
E.R. Gray, III  
David Smoll  
Kent Ward

### INDIANA STATE BOARD OF REGISTRATION

Wes Day - Chairman  
Pat Cunningham  
Ross Holloway

### INDIANA HISTORICAL LANDMARKS

Rollyn Blankenkemper - Chairman  
Ken Anderson  
Jerry Martin  
Vic McCauley  
Nelson Pratt

### SURVEYORS HISTORICAL SOCIETY

Roger Woodfill - President  
Scott Zeigler - Secretary  
Ken Curtis  
E.R. Gray, III  
Randy Sexton

### GREAT LAKES COORDINATING COUNCIL

E.R. Gray, III

### NSPS GOVERNOR

E.R. Gray, III  
Roger Woodfill - Alternate

### INDIANA DEPARTMENT OF TRANSPORTATION

Jake Hall  
Wes Day

### GIS/LIS CO-

Roger  
Gordc  
Mike  
E.R.  
Lar  
Ch

## PRESIDENT'S THOUGHTS

by Randy Sexton, ISPLS President, Kendallville, IN

This quarter I bring you good news and bad news. Lets start with the good news first. It has been brought to my attention that Vincennes University has a record increase in enrollment for the fall term. So much of an increase that they have asked that any one who has spare equipment to loan or donate the equipment to their program. I find this very exciting, along with this being a sign of the future growth in our profession. Then I received a call from Dr. Vincent Drnevich, Head of the School of Civil Engineering at Purdue University. He informed me that they had just hired another professor for the surveying program. The gentleman has received his BS degree from Delf University in Holland, and his MS and Ph. D. from Ohio State. His specialty is in GPS and he is seeking his license in the State of Indiana at this time. That means that two out of the three full time positions at Purdue have been filled. It is my opinion that with these improvements, Indiana schools will again be at the forefront of higher education and surveying advancements in this country and in the world.

Now that I feel as though I have risen to Cloud 9, I unfortunately am forced to quickly return to earth. As I am writing this I see a truck drive up across the street from our office. Out steps a man who immediately straps on what I thought was a carpenters belt. Much to my horror the man begins using a cloth tape and a chaining pin to survey the lot that he is parked in front of. He is all by himself, I presume with the intent of doing a boundary survey. I watched while he completed his work in about a half hour, during which he never set up an instrument to set the Southeast Corner of the lot which he marked with a capped rebar. After the survey was completed I walked over to the site to discuss the job with him. He informed me that probably it was not the correct way to complete the survey, but that he was doing the best he could while still competing with others that he believes are doing a poorer job than himself. I find this lack of professionalism totally inexcusable. In my opinion we owe not only the public a good job, but we owe this much to our fellow colleagues. Yes, I could write up a complaint and file it with the state, but this is not the answer. We must continually educate our colleagues along with having good open communication. Then the most important education that each and every one of us must do every day, is to educate

other real estate professionals as to the importance of a quality survey. Yes, the price will go up a little, however, if we continue in the direction that we have gone in the past, either the corrections later on in time will be very costly or some surveyors are going to have major liability suits which will most likely bankrupt their practices.

Let us all learn from this survey that I witnessed, the importance of quality work, continued education and good public relations with our fellow real estate professionals. It has always been my opinion that the reason the client opts for the cheap survey is that they do not realize the importance of our work and they think that all surveys are created equal. Let's all take a good look in the mirror and ask if we are doing the work of a prudent surveyor.

\* \* \* \* \*

### WANTED! LEGAL DESCRIPTIONS. Unusual - Humorous

Legal descriptions dealing with unusual or humorous terminology, misdescription, odd conveyances or any wills that deal with real property described in an usual manner. Also valued would be deed descriptions which call for monuments or objects unique to your area (i.e. certain trees or landforms).

Example: *Beginning on the lower side of the road leading to Angus McAulay's farm and running all the way below the Vendor's farm until it reaches the top of the hill above the wash brook where the bear tore the blanket...*

If you are aware of a "real gem", a complete copy of the deed, together with the registry reference would be appreciated (date, book and page, county). The purpose of the request is for future publication of a selection of descriptions. Credit will be acknowledged for the contributions used in the publication. Please send to:

Fred Hutchinson, NSLS, CLS  
or  
Allan Owen, NSLS  
F.C. Hutchinson Surveying Limited  
95 Akerley Blvd, Unit A-East  
Burnside Industrial Park  
Dartmouth, Nova Scotia B3B 1R7

## STATE BOARD OF REGISTRATION

Recent Indiana Land Surveyor Registrants

(1990-91)

The following have passed the Indiana land surveying registration examination (and associated educational and experience requirements) during the past two years and are fully registered as professional land surveyors in Indiana with all the rights, privileges, and responsibilities associated there with. Recent statistics show: 1986 - 17; 1987 - 15; 1988 - 43; 1989 - 38; 1990 - 18; and 1991 - 37. (Registrants from 1986-89 were published in the HOOSIER SURVEYOR, Vol. 16, No. 3, Winter 1990, p. 9-11.)

80900001	John J. Myers, Jr., 8775 Shelbyville Rd., Indianapolis, IN 46259
80900002	Stephen D. Servies, 1806 Lora Street, Anderson, IN 46013
80900003	John R. Kurtz, 13705 East 200 South, Columbus, IN 47203
80900004	Ronnie L. Justice, 20243 County Rd 138, Goshen, IN 46526
80900005	Joseph T. Sims, Sr., 1094 Water St., P.O. Box 163, Charlestown, IN 47111
80900006	William E. Pettitt, P.O. Box 412, Hanover, IN 47243
80900007	Steven A. Sherwood, 2017 Vogel Road, Evansville, IN 47711
80900008	John E. Porter, R R 3 Box 161 E, Sunman, IN 47041
80900009	Frank F. Ballintyn, 3207 Julian Drive, New Albany, IN 47150
80900010	Hans C. Hofer, Hofer and Davis Inc., Suite 316, 203 West Wayne Street, Fort Wayne, IN 46802
80900011	David R. Blankenkemper, P.O. Box 157, Jeffersonville, IN 47131
80900012	Dennis D. Olmstead, 12168 Rossi Drive, Indianapolis, IN 46236
80900013	Valdis Lapsins, 3312 Highgrove Place, Dayton, OH 45429
80900014	Philip O. Tapp, 4395 Darrell Drive, Bloomington, IN 47402
80900015	Sam G. Haldiman; Bucher, Willis & Ratliff, Suite 103, 75 Executive Dr., Aurora, IL 60504
80900017	Jeffory W. Darling, 5326 N. Park Avenue, Indianapolis, IN 46220
80900018	Louis J. Bergman, 1093 Howard Drive, Greenville, OH 45331
<hr/>	
80910000	Dennis J. Gobble, 23879 Greenleaf Blvd, Elkhart, IN 46514
80910001	James W. Emans, 1358 Catherwood Dr., South Bend, IN 46614
80910002	Lawrence W. Albaugh, 5555 Glenwood Hills Prky, Grand Rapids, MI 49588
80910003	William Y. Bivins, 4044 Country Place Dr., Newburgh, IN 47630
80910004	Bradley S. Cramer, 920 Broad St., St. Joseph, MI 49085
80910005	David R. Winemiller, 1825 W. Main St., Richmond, IN 47374
80910006	Timothy G. Wolfe, 11716 Lake Circle, Fishers, IN 46038
80910007	Randall L. Byers, 2449 East Lake Shore Dr., Crown Point, IN 46307
80910008	David A. Dries, 11003 Bluegrass Pkwy 690, Louisville, KY 40299
80910009	Brad S. Faris, Apt D, 617 Metairie Drive, Greenwood, IN 46143
80910010	Coventine Fidis, 1637 Plock Rd., Dixon, IL 61021
80910011	Jeffrey G. Stahl, R R 2 Box 376, Chandler, IN 47610
80910012	Bryan F. Catlin, R R 4 Box 281, Clayton, IN 46118
80910013	William L. Clark, 3128 Walnut Drive, Vincennes, IN 47591
80910014	Jacob T. Hawk, 2710 Dellworth St., Columbus, OH 43232
80910015	John W. Lyons, 706 Caliente Dr., Brandon, FL 33511
80910016	Lawrence L. Baumann, 2042 Spyglass Hill Court, Fairfield, OH 45014
80910017	Terry A. Krasko, 37 S. Plains Rd., The Plains, OH 45780
80910018	Lawrence C. Suhre, 9120 Long Run Dr. North, Indianapolis, IN 46234
80910019	Rodney K. Young, 228 S. Harrison Blvd., Evansville, IN 47714
80910020	Robert R. Grove, 4651 E. 300 N., Lafayette, IN 47905
80910021	Harold Gibson, 1105 W. Main St., Greenfield, IN 46140
80910022	William D. Richter, 9833 E. 96th Street, Indianapolis, IN 46256
80910023	Jack K. Smith, 6228 Springbrook Rd., Horton, MI 49246
80910024	Evan J. Evans, 7456 Indian Lake Rd., Indianapolis, IN 46236

80910026 David R. Whitacre, 1 Moock Road, Wildez, KY 41071  
 80910027 Eric S. Doty, 1221 Prarie Brook Dr., Palatine, IL 60067  
 80910028 Charles D. Black, 3531 Hyannis Port Dr., #2B, Indianapolis, IN 46214  
 80910029 James C. Tibbett, P.O. Box 901, Lyons, IN 47443  
 80910030 Timothy W. Smith, 901 High Street, Brandenburg, KY 40108  
 80910031 Roger E. Stephenson, 27872 White Street, Cassopolis, MI 49031  
 80910032 Ronald L. Harner, 10674 Concord Dr., Berrien Springs, MI 49103  
 80910033 Philip D. Beer, II, 1134 Timberlane, Indianapolis, IN 46260  
 80910034 Bryan L. Speicher, 1825 Oakwood Court, Lawrenceburg, IN 47025  
 80910035 Donald L. McLimore, 2625 Frederica St., Owensboro, KY 42301  
 80910036 Curtis D. Ison, Rt 4 Box 198B, North Vernon, IN 47205  
 80910037 Steven A. Bruns, 50 Orchard Lane, Huntington, IN 46750

### IDENTIFICATION NUMBERS FOR FIRMS/AGENCIES

During the past year the Board has assigned identification numbers (according to 864 IAC 1.1-13-19 c) to several land surveying firms or government agencies who made the required formal written requests to the Board. These numbers are to be used on caps permanently affixed to monuments and are used by these agencies in lieu of individual land surveyor license numbers.

0001	Schneider Engineering Corporation, Indianapolis
0002	Warrick Engineering Inc., Newburgh
0003	Blankenbeker & Son, Jeffersonville
0004	Vester and Associates, Inc., Lafayette
0005	Indiana Dept. of Transportation, Indianapolis
0006	Nolan and Gibson Surveying, Greenfield
0007	Bonar & Associates, Inc., Valparaiso
0008	Stoepelwerth & Associates, Inc., Indianapolis
0009	Alan Stanley & Associates, Inc., Greencastle
0010	Pace Engineering, Inc., Shelbyville
0011	Reid, Quebe, Allison, Wilcox & Associates, Inc., Indianapolis
0012	Weihe Engineers, Inc., Indianapolis
0013	Marbach & Brady Land Surveying, Inc., Elkhart
0014	Floyd E. Burroughs & Associates, Inc., Indianapolis

\* \* \* \* \*

### 1992 FALL WORKSHOP, McCORMICK'S CREEK STATE PARK

The Fall 1992 workshop will be held October 2, 1992, at McCormick's Creek State Park. Reservations for rooms at the Canyon Inn are on a "first-come first-served" basis; since the room rate is only \$47.00 and only a limited number of rooms are being held for those attending the workshop, you must act quickly.

The topic of the workshop is Indiana and ALTA/ACSM Land Title Surveys. The presenters will include a lender, lender's counsel, title insurance company representative, borrower's counsel, and land surveyor. One theme of the presentation will be:

Using commercial property as collateral for a loan is an important part of the local economy and a land title survey is one of several important parts of the process of securing the loan. The providers of the several services leading to the closing of the loan need to be aware of each others functions, needs, and areas of expertise. The providers also need to work together as a team to minimize the time and cost to the overall process while maintaining the requisite quality.



McCORMICK'S CREEK STATE PARK  
 Post Office Box 71 / Spencer, Indiana 47460  
 Phone 812-829-4881

### BOARD OF DIRECTORS MEETING

March 7, 1992

by Mike Crawford, reporter

### A FOCUS ON OUR FUTURE

by Perry Cloyd, PLS, Columbus, IN  
 Chairman ISPLS Public Relations Committee

The Board of Directors of the Indiana Society of Professional Land Surveyors held a meeting at the state headquarters on March 7, 1992.

Scholarship was the major topic of discussion. Art Haase and Bill Clark reported on proposed curriculum changes at Vincennes University. The Board gave a unanimous vote of support for the changes and instructed that a letter be sent to the university voicing that support. The subject of the Vincennes and Purdue scholarship funds was also addressed. It was decided that both scholarships be treated as true endowments by adding back to the principal enough money to compensate for inflation. The funds currently being held by ISPLS will be transferred to the appropriate fund. In the future the ISPLS treasurer will track the endowments by receiving quarterly status reports from each fund.

Looking ahead to the 1993 joint convention, a motion was made to allow the Central Indiana Chapter of ISPLS to host the convention. The motion was seconded and passed.

A \$5.00 surcharge will be added to future workshop fees to fund the continuing education program.

The Ethics Committee has developed guidelines for complaints against surveyors. The Board received copies of this document.

New memberships were approved for: Michael J. Davis, Douglas Edward Kramer, and Michael D. Condre.

The next Board meeting was set for April 4th at the Civil Engineering Building at Purdue University.

\* \* \* \* \*

#### LETTER TO ISPLS MEMBERS FROM THE PURDUE UNIVERSITY JOHN McENTYRE ENDOWMENT SCHOLARSHIP RECIPIENT

April 18, 1992

Dear Members:  
 Thank you for making the John McEntyre scholarship available to me this coming school year. It will make a considerable difference on the amount of educational loans that I will require to complete my course work. I appreciate the organization's effort to promote continued education and goal to elevate the prestige of our profession.

Sincerely,  
 Charles D. Graham, Bloomington, IN

On March 22, 1992, ISPLS participated in the National College Fair/Focus on the Future program at the Indiana Convention Center, Indianapolis, Indiana. The National College Fair/Focus on the Future is a first rate operation, with over 6,000 students (high school and college) and approximately 150 colleges and universities represented. ISPLS and surveyors in general had the opportunity to present themselves to a large cross section of the local student population. The largest draw of students was in the exhibits set up by the various colleges and universities. With a nationwide representation, students were able to see first hand the "big picture" of education available.

The ISPLS booth was manned by Dan Pusey and myself with computer assistance supplied by Mr. David Schweikert. Included in our exhibit was a GPS receiver (supplied by MSE Corporation), an Autocad/GIS slide show (provided by Mr. Schweikert) and an exhibit of quad maps, aerial photos, various surveying software, and survey history pictures (supplied by Sieco, Inc.). As a first attempt we were successful in representing the full spectrum of surveying from Cartography to Geodesy to Photogrammetry to the Public Land System and Land Surveying. An active interest was displayed by approximately 25 students and their parents with a distant curiosity displayed by most others who passed by.

I consider this event to be a significant step in the right direction for our profession. The combination of students, schools, and professions is an ideal setup for the promotion of surveying. With our new Registration Board, our Legislative Activity, and our Survey Standards, our foundation for the future is in place. The next step is the education and development of our youth. Our involvement with Focus on the Future has started this process. At this time our profession is not as well recognized as it should be, and further involvement and efforts such as the National College Fair/Focus on the Future are a vital part of the development and growth of surveying in the State of Indiana.

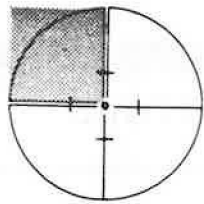

# INSTRUMENT SALES & SERVICE OF INDIANA, INC.

6330 EAST 75TH STREET • SUITE 114 • INDIANAPOLIS, INDIANA 46250

317-849-7090  
Toll Free - 1-800-533-2280

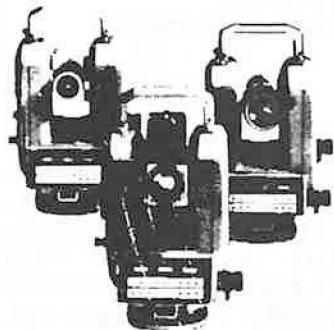

## WILD® HERBRUGG

- Total Stations
- Optical Theodolites
- Electronic Distance Meters
- Plummets
- Lasers
- Computer Systems
- Support
- Electronic Theodolites
- Data Terminals
- Levels
- Tripods
- Gyros
- Surveying Software
- Training
- Accessories



CADserv  
incorporated

RETRIEVER  
AUTOMATED SURVEYING  
& MAPPING SYSTEM  
REFERENCE GUIDE

## AUTOCAD®

## Survey Pac

## D.C.A. & AutoMAP

Software programs that  
run completely  
inside AutoCAD®

Have you ever wondered how you can get a drawing into  
AUTOCAD with lines and symbols in place in under an hour from  
500 raw data points, including Contours and Digital Terrain Model?

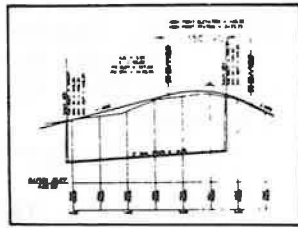
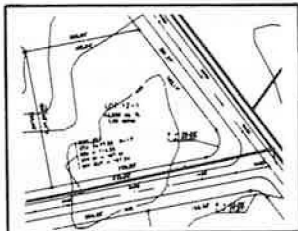
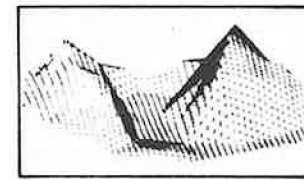
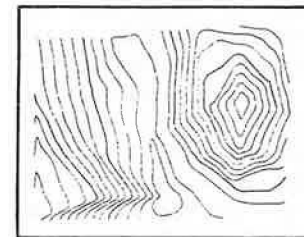

WE SUPPORT WILD, TOPCORN, LIETZ, and NIKON SURVEYING INSTRUMENTS AND DATA COLLECTORS  
WE CAN BRING IT ALL TOGETHER! CALL FOR A FREE DEMONSTRATION

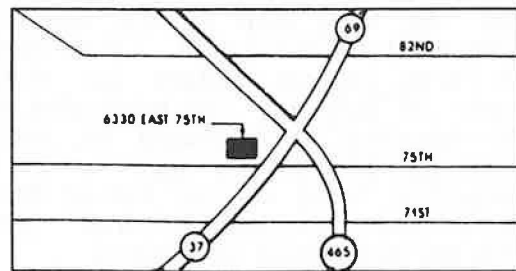

Stop by and have a cup of coffee with us.  
We look forward to serving you!

Hours: M-F, 7 a.m. - 6 p.m.  
Sat., 8 a.m. - Noon (Donuts are on us)

- Computer Systems Sales, Training and Support (Hardware & Software)
- Instruments and Field Support (Sales, Service and Rentals, including FREE Loaners)
- On-Site Demonstrations and Delivery

AutoCAD® is a registered trademark of Autodesk, Inc., Sausalito, CA

## ISPLS SPONSORS WORKSHOPS TO FURTHER EXPLAIN THE MINIMUM STANDARDS FOR THE COMPETENT PRACTICE OF LAND SURVEYING

This Spring the Indiana Society of Professional Land Surveyors has conducted several workshops around the state in order to inform and better interpret the relatively new "minimum standards for the competent practice of land surveying" as proposed by ISPLS and adopted by the Indiana State Board of Registration for Professional Engineers and Land Surveyors to become effective in 1988. Subsequent later revisions were made and became effective August 16, 1991. Each workshop was ably conducted by ISPLS members, Wesley Day and Gary Kent, who are eminently qualified to discuss "Title 864" which has been commonly referred to as "Rule 13". (Has now become 865 IAC 1-12)

Two one-day workshops were held back-to-back on March 19 & 20 on "Rule 13 - Route Surveys" at Holiday Inn - East, Indianapolis. More than 91 surveyors attended these meetings. William Schmidt of Indiana Department of Transportation assisted in these sessions.

Three one-day workshops on "Rule 13 - Property Surveys" were presented by Day and Kent at New Albany (April 10), at Indianapolis (May 1), and at South Bend (June 5). Approximately 140 surveyors attended these sessions. Professional development certificates were issued to all who attended either or both of these continuing education seminars. The profession is indeed grateful to Wes and Gary for their dedication to this upgrading of land surveying standards.

## INDIANA SURVEY STANDARDS - RECENT HISTORY

by Wesley Day, Whiteland, IN

1958

- \* First ISPLS Survey Standards adopted.

1959

- \* 1958 Standards revised

1981

- \* The Indiana Registration Act required the Registration Board to establish rules for the competent practice of land surveying.

1986

- \* ISPLS Indiana Survey Standards established.

**PURPOSE:** To establish rules for the competent practice of land surveying. In regard to property surveys, to provide for:

- \* Minimum quality
- \* Uniform quality
- \* Uniform monumentation
- \* Simple positional accuracy of lines & corners.
- \* A surveyor's report in simple terms regarding the type & amount of theoretical uncertainties in measurements & actual uncertainties in descriptions, monuments, & possession.
- \* Showing the relationship of surveyed tract to adjoining.

- \* Recording some property surveys to provide a continuous survey chain of history & thereby provide data for use in future surveys, tax mapping, & title company records.

THE MAIN TOPICS IN THE 1986 STANDARDS WERE:

- \* Land Surveyor Responsibility
- \* Property Surveys
- \* Data Accumulation Surveys
- \* Construction Surveys

1988

The 1988 State Survey Standards were a modification of the 1986 ISPLS Standards.

1991

The 1988 State Survey Standards were revised as follows:

- \* DELETED:
  - Data Accumulation Surveys
  - Construction Surveys
- \* ADDED:
  - Route Surveys
  - Surveyor Location Reports
- \* REDEFINED:
  - Numerous Items

It is by now very obvious that usage is the best test for survey standards. All suggestions for revisions will therefore be welcomed by the ISPLS standards committee.

## OPEN LETTER TO ISPLS MEMBERS

From: ISPLS Governmental Affairs Committee, Gary R. Kent,  
Chairman

Re: ISPLS 1993 Legislative Goals

Until the 1991 legislative session, our accomplishments in the legislative area were almost non-existent! However, as a result of a planning and goal setting session arranged by then President John V. Schneider, we were, for the first time, well focussed and organized.

We had; a simple, but long, bill to create separate registration boards for land surveyors and engineers; excellent sponsors in both the house and the senate; an excellent, well respected lobbyist with a proven track record; a highly motivated governmental affairs committee; JAKE HALL; an untested "minuteman" program; and, the assurance of more than a few people in politics, government, and ISPLS that we didn't have a prayer of succeeding!!!

It was touch and go, but because the above people didn't have enough sense to know they couldn't do it, because they worked very hard and effectively, and because they had a lot more luck than anyone could have expected (some bad, most good), we succeeded in passing our bill! The nay-sayers were wrong! They underestimated our entire organization, especially our "minutemen". Even with some minor flaws in the basic operational design, the "minuteman" program worked beautifully when we desperately needed to get a committee hearing for our bill.

Once again we have an important legislative program developed from the 1991 goal setting program arranged by 1991 president Ross Holloway and now being pushed along by president Randy Sexton. We will have two bills for the 1993 legislature. The first is a bill to enable the Land Surveyors Board to develop and utilize a professional development (continuing education) program. The second is a bill to update and revise the land surveyor registration act. This bill was initiated by then chairman William Hill of Land Surveyors and Engineers Board about two years ago. A subcommittee of that board, continued by the current Land Surveyors Board chaired by John McNamara, and including an ISPLS member, has worked diligently since then to get this bill ready for the 1993 legislature. Copies of these bills should be available shortly for your review and suggestions. Please look them over carefully and mail your suggestions to ISPLS headquarters as soon as possible.

We will have the same super team this time but with more experience. Since the "minutemen" probably saved us in 1991, we call again for your assistance. However, in order for you to work as effectively, if not better, we need to have more current and accurate information and we need more minutemen!

We urge you to immediately fill out the following Minuteman questionnaire and mail it to the address given. It is imperative that we have your enthusiastic support!

WE CAN DO IT AGAIN !!!!!

---

### MINUTEMAN QUESTIONNAIRE

Minuteman Name:  
Street Address:  
City/State/Zip:

Area code/Phone no.  
Office : /  
Home : /  
Fax : /

My fax is: Manual \_\_\_\_\_ Automatic \_\_\_\_\_

Politicians I know who might help:  
Indicate position: House, Senate, Gov. Office, Other (In 1991, the uncle of one L.S. may have been a key player in our success!)

- 1.
- 2.
- 3.
4. (See attached sheet) \_\_\_\_\_

Please check one or more of the following:

\_\_\_\_\_ I am willing to be a leader and serve as an area coordinator and call or fax five other ISPLS members if the Minutemen's help is needed in 1993.

\_\_\_\_\_ I am willing to contact my representative, senator, the governor's office, or anyone else who can help get bills passed that will better the profession or benefit the public.

\_\_\_\_\_ I am mailing a check for \$ \_\_\_\_\_ (\$40 per member would be a tremendous help for the PLS PAC to assist our legislative program.) Please make out your check to "PLS PAC" and mail it to their attention at ISPLS Headquarters. Note- "Contributions or gifts to the PLS PAC are not deductible as charitable contributions for federal income tax purposes." (Section 6113 of the internal revenue code)

Please return your completed Minuteman questionnaire to:

ISPLS Headquarters  
Attn: Government Affairs Committee  
55 Monument Circle, Suite 1222  
Indianapolis, IN 46204

## NATIONAL PRESIDENT FOSTER CHALLENGES SURVEYING ORGANIZATIONS Address to ACSM

Robert W. Foster, PE,LS

1992 ACSM Annual Meeting - Albuquerque, New Mexico

We have been living through the most extraordinary period in history. We are coming to the end of a Cold War that has gone on longer than some of us can remember. It has been a cold war that threatened to destroy us. A Cold War that has sapped our strength and resources and has filled a whole generation with despair.

Will we be able to forget old injuries, and put aside old grievances?

Economies are in ruins because of that Cold War; what will be the cost in energy and resources to rebuild?

As we arrive at the end of the Cold War we anticipate that there will be a peace dividend. The debate has already begun: How shall we spend this peace dividend?

Perhaps the most important question is, What have we learned from our Cold War experience? What wisdom can we leave for our successors, so that they may avoid another Cold War?

\*\*\*\*\*

In speaking of the Cold War I mean the Cold War that has raged within ACSM for the last three years... As this Cold War approaches its end, we ought to consider several issues:

We must forget old injuries and old grievances. We must, if we are to regain the confidence of a membership grown tired of our conflict.

We did not quite attain financial ruin as a result of our Cold War - but we came close. We must rebuild financial stability, defined as a comfortable reserve fund. That process has begun. We must continue it.

If there is a "peace dividend" at the end of our Cold War, it will be in the energies of the leaders that may now be directed to serving the membership. Abraham Lincoln said, "They have a right to criticize who have a heart to help." Some of us have been spending our energies firing off letters of indignation to each other. We must find equally creative ways to reconstruct ACSM as an effective, truly representative association of surveying and mapping professionals.

What have we learned from our experience of three years of Cold War? I believe we have learned some valuable lessons:

- We have learned that we care about our profession. It is because we care that we were willing to invest so much time and energy in changing ACSM to the vision each of us has had for it.

- We have learned that we have a committed leadership that has stayed on through a long and sometimes bitter struggle. Surely the leaders in place to-



day, having survived ACSM's Cold War, are well equipped to rebuild ACSM and its Member Organizations to a place of national respect.

- ACSM is made up of members in private practice, members in government, and members in education. We are cartographers and surveyors. We are boundary surveyors and geodetic surveyors, engineering surveyors and surveying engineers. We have learned that there is strength in our pluralism. ACSM is a forum where members in private practice can exchange ideas with members in government. Surveyors and mapping scientists have learned that the GIS explosion will bring their disciplines ever closer together. We are privileged to have as our members some of the leading educators of the finest surveying and mapping programs in the United States. We have, indeed, learned that there is strength in our pluralism.

- We are a geographically diverse association. We have members and affiliates from every state. We have Sections of ACSM from the major population centers of the country. We have an untapped political power in that every U.S. Congressman could be contacted by an ACSM constituent in hours - if we ever coordinate our efforts to lobby for worthwhile legislation. But our geographic diversity has created a regional divisiveness that is damaging to all of us. Attending a meeting in California last month I was struck by the enormous energy and enthusiasm of the surveyors there, in support for their profession. Yet I also discovered a pernicious misconception that ACSM is an East Coast institution, unaware of the problems and concerns of surveyors on the West Coast. I don't know how that idea got started, but it must be corrected. We are all the poorer for the loss of support of professionals from the largest single population group in the United States. We have learned - I hope that we have learned - that we are one national association whose strength comes from our pluralism and our geographic distribution.

\*\*\*\*\*

In the words of one NSPS leader, the National Society of Professional Surveyors has "achieved that greater degree of autonomy ... we asked for." Now NSPS must show what it can do with this new-found autonomy. NSPS leaders have begun to identify priority programs for the coming year and I would not change the focus of those programs. But I will issue a few challenges to all our leaders:

- I challenge NSPS to take a more pro-active position in the issue of surveying education. Education is the main means of social, cultural, and economic advancement for people everywhere. The advancement of our profession in America will be determined largely by the quality of education available to our

## Robert W. Foster Address to ACSM (Cont)

entry-level surveyors and mapping scientists in the 1990s and the 21st century beyond.

In the words of Professor Ben Buckner, Surveying Program Coordinator at East Tennessee State University, "Educators cannot themselves be the primary preachers on surveying education." Professor Buckner quotes a 1988 NSPS resolution to "support and encourage the development of Regional education centers..." and correctly argues that the impetus for the creation of these programs must come from the profession. In education demand must always precede supply.

I challenge NSPS to dust off that 1988 resolution and create an action program to support and encourage regional centers for surveying education. ("Academic Common Market")

- Surveyors in private practice must get involved. We must influence the design of 2 and 4-year programs for surveying and surveying engineering to serve the needs of private practice. The programs will not help those of us in private practice by serving government and industry exclusively.

- Surveyors in private practice must get involved in program accreditation. The ABET accreditation teams have a hard job to do, and they have performed well doing it. But the ABET teams have been made up largely of educators. Surveyors in private practice must get involved in this process if the schools are to produce graduates prepared for private-practice surveying.

- I challenge all ACSM members to get involved in the financial support of our college and university surveying and mapping programs. The surveying industry of California donated \$33,000 in scholarships to students in the Fresno Surveying Engineering program last month. Through the New England Section of ACSM the profession has supported the surveying engineering program at the University of Maine at Orono with more than \$150,000 donated in the last decade. These efforts should be a model for surveyors and mapping scientists everywhere.

- I challenge NSPS to reconsider the definition of surveying. Surveying is not a civil engineering discipline; it has not been for at least the last 25 years. The question is this: Is surveying an engineering discipline?

There are currently five major institutions granting bachelor of science degrees in Surveying Engineering in the United States. Is surveying for them related to engineering, or is it, in fact, an engineering discipline?

Let's recognize reality.

Let's prepare for the emerging "surveying engineer."

The growth of GIS/LIS; the reconstruction of America's infrastructure; the opening of the borders between the United States and its neighbors to the north and south, make it vital that we re-examine the definition of surveying in America.

At the same time surveying education itself is being redefined. In 1990 ACSM formed a panel, with other surveying and mapping organizations, to conduct a National Study on Surveying and Mapping Education. A draft of the panel's report is available here in Albuquerque. The report predicts a new umbrella discipline, which includes land information management as well as the familiar surveying/mapping activities of data capture, data processing, and data display and storage. A colorful array of titles have been suggested for this new umbrella discipline: mapping science, surveying engineering, geo-engineering, geo-information, geo-informatics, and geometronics are a few. The report suggests Spatial Information Mapping and Analysis as a reasonable combination of terms.

Everyone with an interest in surveying education - everyone with an interest in the future of surveying - should read the report of this National Study. The dramatic technological advances we have seen in the past quarter century may be dwarfed by the institutional changes about to take place in the surveying/mapping profession.

- I challenge ACSM: What is to be our role in GIS/LIS? David Tyler, Chair of our Education Committee and Chair of the Surveying Engineering Dept. of the U. of Maine at Orono, (Nov/Dec *Professional Surveyor*) pointed out that surveyors have failed to

embrace GIS as a technology. "I really thought 15 years ago that the surveying community would play a key role in the development and implementation of GIS. I have not seen that happen." Tyler's recommendation: "Take the blinders off and go beyond the notion that surveyors are just collectors of data." There is a challenge there, not just to NSPS, but to all 3 MOs, and to ACSM as an entity. Cartographers, geodesists, and surveyors all have a role to play in the GIS explosion. We look for ways to create a 4th member organization in ACSM - a home for the GIS specialist - and I support that effort. But we must also recognize the role that each of our Member Organizations has in GIS and encourage more activity at the Member Organization level.

We must acknowledge the importance of the membership profile of ACSM. There must be a close association of cartographers, geodesists, and surveyors. ACSM provides a congress for the meeting together of these disciplines, and in that respect will always be more than a mere "administrative body" playing an exclusively administrative function.

Joseph Bordogna, Dean Emeritus of University of Pennsylvania School of Engineering and Applied Science said recently: "The ability to make connections among specialized areas of knowledge, to understand the relationships among seemingly disparate discoveries, events, and trends, and to integrate them in ways that benefit the world community will be the hallmarks of modern leaders."

- I challenge the leaders of NSPS, AAGS, and ACA to "make the connection between your specialized areas of knowledge" and integrate them in ways that benefit our whole profession.

I have the pledge of the incoming presidents of each of the Member Organizations, that we will work together in 1992. We will have communication instead of confrontation. We'll have cooperation instead of conflict. I challenge all the leaders of our three Member Organizations to engage in the same communication and cooperation. The time for criticism is past. In Lincoln's words, let those with a heart to help - help.Ω

The Empire State Surveyor May 1992

# G. LENGEMANN CO.

SURVEYING - CONSTRUCTION - DRAFTING  
EQUIPMENT AND SUPPLIES  
COMPLETE SERVICE DEPT.

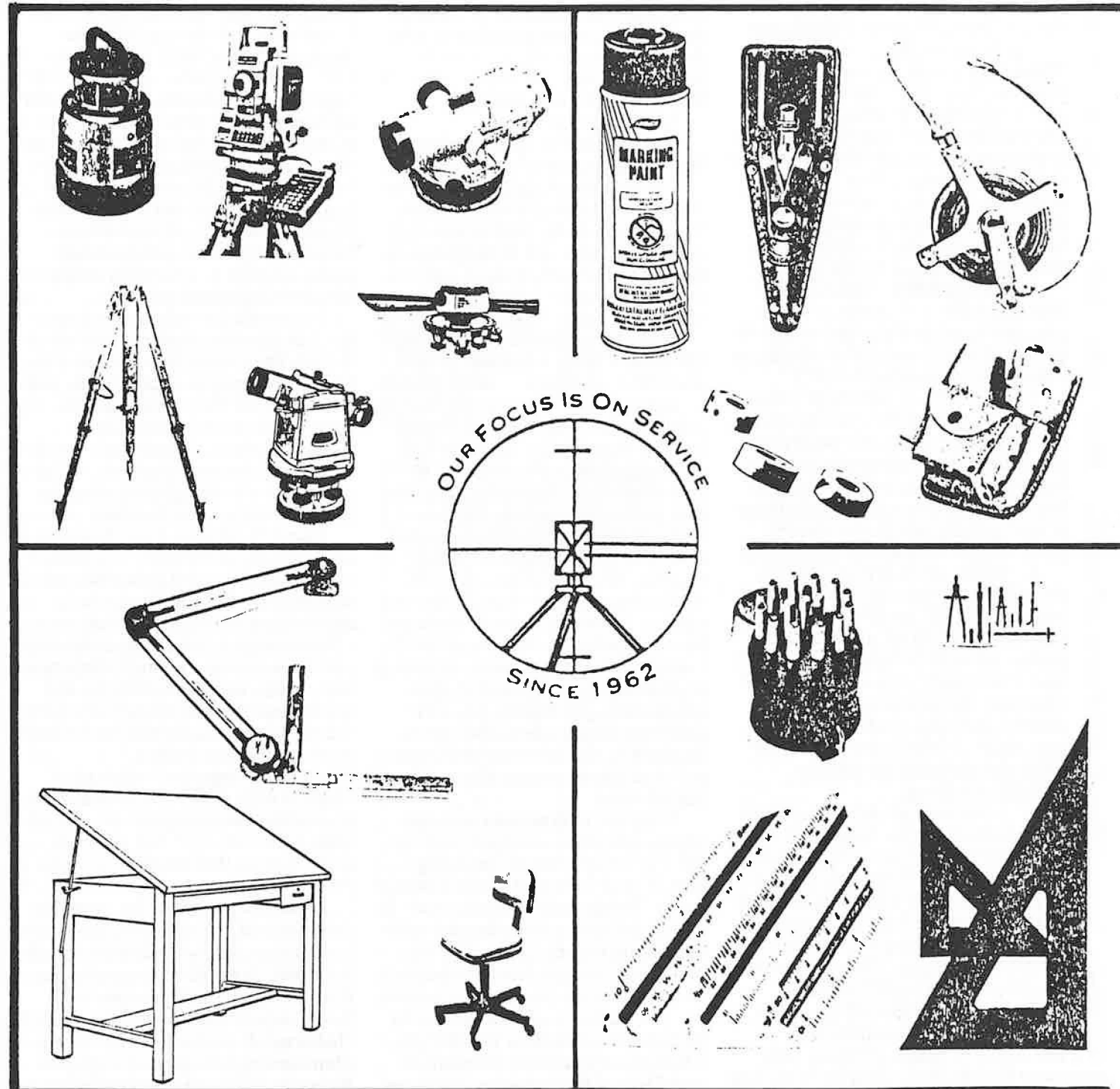

2314 N. 5TH ST.

NILES, MICHIGAN 49120

1-616-684-2116

TOLL FREE 1-800-632-3923

FAX 1-616-684-1588

## PROFESSIONAL DEVELOPMENT IN INDIANA

by Anthony Gregory,  
Chair Professional Development Evaluation Committee

In early 1991, the Professional Development Evaluation Committee of ISPLS was charged to develop a program for the professional development of land surveyors in Indiana. This charge followed years of discussion regarding mandatory and/or voluntary professional development and continuing education. ISPLS and most surveyors registered in Indiana knew that the implementation of such a program was essential in order to keep practicing surveyors current in a field which is constantly changing and advancing.

The committee researched existing and proposed programs from over 20 states, and also consulted with the National Society of Professional Surveyors (NSPS). The goal of the committee was to develop a program which would satisfy the mission of keeping a surveyor current in his or her field, but one which would not be a burden to them. In addition, the committee felt that professional development meant more than just attending workshops and seminars. The program was structured to include activities in surveying practice, research, membership and service to surveying associations, and community service.

Different states measure activities in professional development and continuing education by different units. The most commonly used unit is the Professional Development Hour (PDH). Simply stated, one (1) hour of acceptable professional development activity is equal to one (1) PDH. Many states have incorporated the PDH system into their programs, and conversions of other types of units such as Continuing Education Units (CEU) or college credit hours have become standard. For the most part, the committee followed the recommended unit and conversion system suggested in a model law for continuing education and professional development prepared by NSPS. The committee recommended that thirty (30) PDH be required every two (2) years for a participant to successfully complete the program.

The completed program, which follows this article, was presented to the general membership of ISPLS at the 1992 convention in Columbus. Since legislation is not yet in place to enforce a mandatory professional development program, ISPLS has chosen to operate the program on a voluntary basis. This will allow the practicing surveyors to get accustomed to keeping track of activities to satisfy such a program. In addition, ISPLS will be able to

determine if any revisions are needed, and to see what type of administrative effort is necessary to make the program work. The program was developed to be operated on either a voluntary or mandatory basis. Therefore, no major changes should be needed when legislation for mandatory professional development is put in place.

Professional development should not be looked upon as a burden. An average surveyor who is a member of a surveying association or society would only have to attend one or two seminars or workshops per year in order to successfully complete the program.

We work in a profession in which technology changes are continually causing us to work with higher accuracies and precisions. The legal responsibilities which we are exposed to are always getting more complicated. We need to continue our education and professional development if we are going to keep up with these changes.

Professional Development Evaluation Committee:

Richard Hudson  
David Pilz  
Gordon Richardson  
Anthony Gregory, Chair

### KEN CURTIS RESPONSE

I want to take this opportunity to thank those who were responsible for the tributes extended to me at the ISPLS Annual Meeting in Columbus in January. To dedicate the meeting to me was unbelievable! Special thanks go to Evan Bayh, Sheila Klinker, Ross Holloway, Jake Hall, E.R. Gray III, Orwic Johnson, Pat Cunningham, John McEntyre, Randy Sexton, Dianne Bennett, Bradley Ott, and many others. I love you all!

My on-campus retirement dinner was held in conjunction with the Purdue Senior Recognition Dinner on April 4, 1992 and many current students, former students, faculty, and friends attended. It was a great evening! Thank you all! I have been blessed with a wonderful career and the loving companionship of my wife, Mary Lou, for forty-five years. I still intend to be an active participant, but in a different manner.

Sincerely, Ken Curtis

## ISPLS VOLUNTARY PROFESSIONAL DEVELOPMENT PROGRAM

"Professional Development" as used in this program is made up of the efforts a participant makes to grow as an individual and as a professional in the field of surveying. It involves education, self-study, research, participation, contribution and service. It is measured in continuing education, teaching, research studies, membership and participation in professional service and related societies and organizations, and various service activities.

The program is a project of the Indiana Society of Professional Land Surveyors, Inc. (I.S.P.L.S.). It is an effort to stimulate genuine professional development in its members and raise the conscious of the general population to that professionalism. Participation in the program is voluntary and is intended for, but not limited to, members of I.S.P.L.S.

Participants shall be responsible for maintaining a file of their records of participation including dates, content, duration, registration receipts and other appropriate documentation. Application for recognition under this program shall be made on a bi-annual basis at the same time as society membership renewal. Application shall be made on forms

provided. Along with that application, the participant shall also provide any relevant documentation substantiating his/her professional development efforts.

Appropriate I.S.P.L.S. committee(s) shall be responsible for receiving and reviewing all applications and data, determining the various activities that qualify under this program, and all other administrative duties. The committee(s) may waive any or all of the program requirements when hardship or other extenuating circumstances exist. The decisions of the committee(s) are final and not subject to appeal.

Participants will earn units towards the program goal in the areas of SURVEYING PRACTICE, PROFESSIONAL DEVELOPMENT, EDUCATION, and COMMUNITY SERVICE, as detailed on the following pages. A participant who is determined to have met the requirements of the program by successfully obtaining thirty (30) Professional Development Hours (PDH) will be recognized as a "DISTINGUISHED SURVEYOR" for his/her efforts towards professional development.

### SECTION 1: UNITS

(Credit for any single activity shall not be given in more than one category.)

1 Hour of acceptable professional development activity	....	1 PDH
1 Semester hour of university credit	.....	15 PDH
1 Quarter hour of university credit	.....	10 PDH
1 CEU (Continuing Education Unit)	.....	10 PDH

### SECTION 2: SURVEYING PRACTICE (2 PDH minimum - 8 PDH maximum per renewal)

(a) The practice of land surveying shall be counted as follows:

100 to 719 hours of practice per year	.....	1 PDH
720 to 1399 hours of practice per year	.....	2 PDH
1400 hours or more of practice per year	.....	3 PDH

(b) Full-time practice in an approved land-surveying occupation ..... 1 PDH per year

(c) Teaching land surveying courses in a degree granting program at an university.  
 Part-time employment..... 1 PDH per year  
 Full-time employment..... 3 PDH per year

(d) Successfully obtaining a registration in another state other than Indiana..... 1 PDH per state only when obtained

### SECTION 3: PROFESSIONAL DEVELOPMENT (4 PDH minimum - 18 PDH maximum per renewal)

(a) Publication and/or presentation of a surveying professional paper..... 2 PDH

(b) Presentation at surveying related meeting..... 1 PDH (not included in (a) above)

(c) Membership in local, state or national surveying societies ..... 1 PDH per society per year - 3 PDH per year maximum

(d) Service as an officer or committee member of a surveying society or of a board associated with the surveying profession ..... 1 PDH per committee per year

(e) Attendance of surveying society meetings/conferences (state, regional or national - 2 day minimum)..2 PDH per conference

(f) Attendance at 50% or more of surveying association's local chapter meetings (minimum of 3 meetings per year must be attended and certified by Chapter President)..... 2 PDH per year per chapter

(g) Preapproved independent research and investigation ...Up to 3 PDH per year - at discretion of board or ruling committee

### SECTION 4: EDUCATION (8 PDH minimum - 18 PDH maximum per renewal)

(a) The completion of courses, or the attendance of seminars or workshops directly related to the surveying profession shall be counted as per Section 1.

(b) The completion of courses, or the attendance of seminars or workshops not directly related to the surveying profession, yet deemed acceptable by board or ruling committee shall be counted as  $\frac{1}{2}$  of PDH credit as per Section 1.

(c) The presentation of a seminar or workshop directly related to the surveying profession shall be counted as per Section 1.

### SECTION 5: COMMUNITY SERVICE (0 PDH minimum - 4 PDH maximum per renewal)

Membership and activity with community and civic organizations (not surveying related) ..... 1 PDH per organization per year

Isn't It Time You Moved Up To

Today's Technology From Leica?

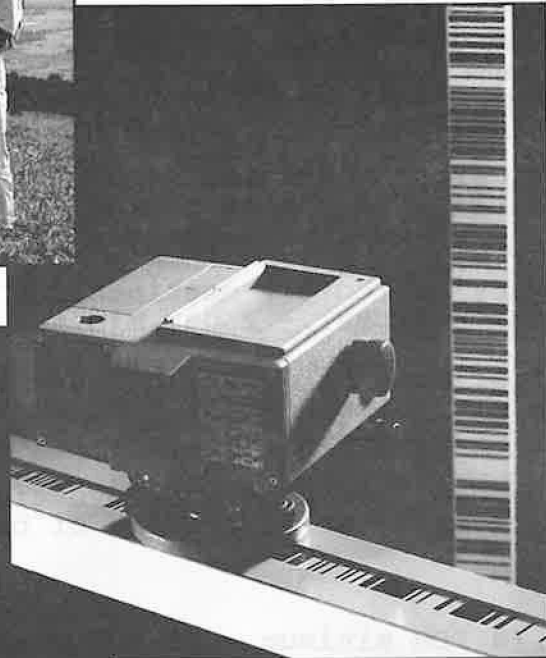

**Take the lead in Productivity with Four Great New Systems from Leica!**

**WILD GPS-System 200**

The only GPS System featuring Rapid Static with or without P-Code! The fastest, easiest high-accuracy surveying GPS system ever developed.

**WILD VIP Total Stations**

Versatile, Individual, Programmable instruments to make your fieldwork fast, simple, and accurate.

**WILD GPC1 Data Terminal**

A true MS-DOS field computer with virtually unlimited storage capacity. Choose from Leica's library of powerful software, or add your own!

**WILD NA3000 Digital Level**

Precise leveling with speed, accuracy, and automatic recording.

Advanced technology at affordable prices. Your Leica Representative can show you the most important and newest innovations in surveying.

Leica Inc. • Deerfield, IL 60015 • Telephone 1-800-645-9190 or 1-708-405-0123 • Fax 1-708-405-0036

With its WILD HEERBRUGG, KERN SWISS, and CAMBRIDGE INSTRUMENTS product lines, Leica provides the most complete range of instruments and systems for survey tasks. Leica plc, with 11,000 employees worldwide, is a group of companies formed in 1990 by the merger of Cambridge Instruments and Wild Leitz. It also makes and sells the world-famous Leica range of microscopes and microtomes, and Leica cameras, binoculars, and projectors. You can obtain Leica advice and service in 128 countries.



**NSPS GOVERNOR'S REPORT**

ACSM-ASPRS Spring Convention, Albuquerque, New Mexico  
by E.R. Gray III, L.S., Columbus, IN

Albuquerque, New Mexico, founded in 1706, was the site of the Spring 1992 ASPRS/ACSM Annual Meeting and Convention. Albuquerque spreads over 100 square miles with elevations ranging from 4,500 to 6,500 feet and is located on the banks of the Rio Grande. Even though it rained for two days straight, Albuquerque is noted for its mild, dry climate. Visitors to Albuquerque should visit Old Town, ride the Sandia Peak Tramway and dine at the High Noon, where Jalapenos Peppers rate only a 5.5 on a scale of ten. The following meetings were attended:

Friday, February 28  
NSPS Board of Governors, "Think Tank", planning for the future.

Saturday, February 29  
New Governor Orientation, NSPS Board of Governors Meeting.

Sunday, March 1  
NSPS General Membership Meeting, NSPS/ACSM Survey Technician Certification Board, ACSM Awards and installation of officers, Surveyors Historical Society Meeting.

Monday, March 2  
Board of Registration Forum, County Surveyors Forum, ACSM Code of Ethics Committee, ACSM/NSPS Annual PAC Auction.

Tuesday, March 3  
NSPS Board of Directors Meeting.

Wednesday, March 4  
ACSM Board of Direction, New Mexico Association of Surveyors and Mappers Auction.

In a nutshell, I attended six days of meetings that lasted a minimum of eight hours each day.

The following is a synopsis of some of the meetings attended:

**NSPS, INC.**

The National Society of Professional Surveyors, Inc., Member Organization, is now being recognized as the successor to the National Society of Professional Surveyors. ACSM began transferring NSPS funds to NSPS, Inc. on January 1, 1992. Most of the NSPS, Inc. Governors, and NSPS, Inc. Committee meetings were directed at a new beginning and future goals of NSPS, Inc.

**NSPS, INC. BOARD OF GOVERNORS  
"THINK TANK"**

There were five task committees assigned

to provide NSPS, Inc. with direction on such topics as: private practice, education, standards, public relations, equal opportunity, budget and finance to name a few.

It was the Board of Governors consensus that the State Surveying Associations should be directly affiliated with NSPS, Inc. Currently the State Surveying Associations have Articles of Affiliation with ACSM. A new Article of Affiliation was drafted by the NSPS, Inc./State Affiliate Relations Group on which I served. The Articles of Affiliation between NSPS, Inc. and applicable State Societies speaks to the purpose of obligations and responsibilities of both parties involved. I feel this will serve to establish better channels of communication between the various State Societies and NSPS, Inc. A final draft will be published in the next Hoosier Surveyor and presented to the ISPLS Board of Directors for consideration and adoption.

**NSPS, INC. BOARD OF DIRECTORS**

NSPS, Inc. Board of Directors meeting was called to order at 8:09 on March 3, 1992. All members were present except Nick Mozzachio.

President Richard E. Lomax of Michigan presided. ACSM Executive Director, John Lisack, congratulated NSPS, Inc. on achieving its corporate status and wished the organization good luck in the future.

The ALTA/ACSM Committee reported on their progress of the 1988 standards revisions. John Thalacher expressed that the standards should come under the review of NSPS, Inc., rather than ACSM. It was agreed to approve the standards under the current relationship and then look into changing the liaison. After some minor changes the standards were approved and sent to the ACSM Board.

Bob Foster spoke on professional liability and noted that because of an increase in the number of insured firms, approximately \$500,000.00 will be returned to the 500 firms insured in 1987.

Pat Hutchinson spoke in favor of merging the Women's Forum with the Equal Opportunity Committee.

**Joint Government Affairs Committee**

Nancy Parke, Joint Government Affairs Director, will be reviewing the concern of the removal of railroad tracks being the primary R/W monumentation with the Interstate Commerce Commission to see if proper

remonumentation can be resolved by administrative action. Contact's with Congress are being made to address the use of erroneous information used to prepare the Fema Maps. There will be an Oversight Hearing on the House Sanctioned Committee of the Fema Program. An invitation has been extended to ACSM to participate in a panel that will be discussing problems with the Fema Maps and Program, the use of erroneous information used to prepare the Fema Maps. Concerns were expressed to Nancy that the Department of Labor had downgraded the profession of Surveying to a technical status. She will be investigating the issue further. Maybe with the NSPS on a new road more action on this issue will be coming soon.

#### State Affiliation with NSPS, Inc.

The Board agreed to send the new Articles of Affiliation to the state societies. Once the final Articles of Affiliation are in hand they will be presented to ISPLS for approval. The articles provide for the state to send a representative, Governor, to the Board of Governors meeting with issues of state concern and voting rights.

#### Membership Renewal Inducement

A motion was made by Area 2 Director Joseph M. Dolan that NSPS Board approve a 25% discount to be matched by ACSM, in the dues for one year to those members who have failed to renew their membership over the past three years. The offer is to be mailed on June 1, 1992 and expire September 1, 1992.

#### NSPS Surveyor's Creed and Cannons

It was noted that there was little response to the proposed Creed and Cannons published in the January/February 1992 ACSM Bulletin. The Board voted to send the Creed and Cannons to publication. The previous ACSM Code of Ethics fell under critical review and analysis by the FTC resulting in their being rescinded March 29, 1991 by ACSM.

#### Replacement of NSPS, Inc.

##### Director on the ACSM Board

John Dailey of Cleveland, Ohio was elected to replace Jack Fitch on the ACSM B.O.D. Jack had resigned because of personal reasons.

#### NSPS, INC. BOARD OF GOVERNORS

Jim Granger, Chairman, presided with 46 Governors, an apparent record, in attendance along with numerous guests.

Curt Sumner of Virginia was elected Chairman with Bob Foster being re-elected as Secretary.

#### NSPS, Inc. Coordination

Patricia A. Canfield began January 1,

1992 as the full time Coordinator to NSPS, Inc.

#### Certified Survey Technician Board

The certified Survey Technician Program, effective January 1, 1992 is now under the guidance of NSPS, Inc. The program was previously in the hands of ACSM. Level I, II, and III of the program are presently available with the goal of having Level IV available in late 1992. The Board is interested in suggestions for questions. More than 200 Program Information Booklets have been mailed out since the Fall Conference.

#### National Geodetic Survey Mark Maintenance

Edward J. McKay of NGS presented a report on Mark Maintenance. Seven years ago the Mark Maintenance line item was cut and NGS got away from doing Mark Maintenance. To offset that, NGS developed the Geodetic Mark Presentation Guide Book in March 1990. Users of NGS Reference Marks willing to assist in preserving the network then had available instructions for the relocation and preservation of such marks. That guidebook is now being updated. Governors from each state were provided copies to take back to their state for review and comment. McKay said he didn't foresee the Mark Maintenance Program ever coming back like it was originally.

#### Boy Scout Surveying Merit Badge

Publication of the rewrite of the Boy Scout Surveying Merit Badge requirements should be out in April of this year. Although I did not get a chance to look over the rewrite, I have worked with the old requirements and am optimistically awaiting the new ones. This is a grand opportunity for you to get involved with your local Boy Scouts.

#### Construction Standards Sub-Committee

Albert D. Frieze, Jr. provided the state governors draft copies of the construction layout standards to carry back to their respective states for comment.

#### Computer Reports

A computerization of committee reports committee was formed and charged with providing a computerized report of standards for the computerization of committees reports. Say that one fast!

#### Publications

A motion was made by Robert Prescott to ask the NSPS B.O.D. to suggest recommendations to get the business of NSPS to the membership of NSPS.

#### Railroad R/W

David J. Sherrill, Illinois Governor, made a motion requesting that the Board of Governors, NSPS Board, and the ACSM Board submit minimum monumentation requirements for the abandonment of railroads to the interstate commerce commission for action.

#### GPS in Florida

The Florida Governor reported the GPS work in Florida falls under jurisdiction of a Registered Land Surveyor. Florida recommends that all states seek changes in their state to require that Land Surveyors must supervise and certify to GPS Services.

#### Installation of NSPS, Inc., Officers

Richard E. Lomax; President  
James Boyer; President/Elect  
Sam Best; Vice President  
John L. Thalacker; Secretary/Treasurer

#### Installation of ACSM Officers

Robert W. Foster; President  
Richard E. Dahlberg; President/Elect  
A. Nicholas Bodnar; Vice President  
Richard E. Lomax was installed as a member of the ACSM Board of Directors because of his position of NSPS, Inc., President.

#### SURVEYOR'S HISTORICAL SOCIETY

Upon arriving to the scheduled meeting at 1:00 p.m. and finding no one in attendance I decided to return at 2:00 p.m. A quorum was finally declared at 3:10 p.m., but only after John Thalacker, Treasurer, became disenchanted and left.

Michael G. Shackelford, Chairman, presided. The Society shows cash assets of \$13,619.47 as of December 31, 1991 with an operating budget in 1992 of \$14,526.00

The purchase of additional banners was discussed. It was suggested that chapters wishing to use the banners should place requests further in advance of their need. Also, chapters may consider purchasing their own banners.

Motion was made and carried to work with Roger Woodfill concerning the Membership Enhancement Program.

SHS will be sending a full page add to State Societies to run their newsletters to encourage membership in SHS.

Russell Kastle presented a report from the Historical Mark Presentation Committee along with a \$100.00 check for the formal application of the "Raleigh Longitude" site for inclusion into the program. Brochures totaling 2,000 have been printed promoting the SHS National Registry.

The Michigan State Society will be providing administrative services to SHS free of charge until an accurate chart of administrative expenses can be arrived at. Once this happens, SHS may enter into a contract for administrative services with Michigan.

#### STATE BOARD OF REGISTRATION FORUM

Model minimum standards for the practice of Land Surveying booklets were provided to interested parties in attendance.

The booklet is prepared by the National Council of Examiners for Engineering and Surveying.

#### GREAT LAKES REGIONAL COUNCIL

The meeting was called to order by Alden M. McGee, Chairman, David J. Sherrill presented the treasurers report indicating the council had a balance of \$968.82.

State packets were exchanged and Illinois expressed concern about railroad tracks being removed without proper monumentation being established. Illinois is suing the railroad under the Plat Act.

Chuck Tapley reported on the new NSPS, Inc. Articles of Affiliation, and indicated his support for them.

It was noted that communications with the Bureau of Land Management has improved.

Again, Computerization of Committee reports was discussed.

This was one of the more enjoyable meetings I attended. I hope to report more on the activities of the Great Lakes States in future writings.

#### FOR YOUR INFORMATION

To obtain Flood Maps contact the Federal Emergency Management Agency (FEMA) at (800) 333-1363

#### Is That You, Son?

Two mothers were talking. "I think my son's home from college," the first mother said.

"What do you mean, you THINK he's home?" her friend asked. "If you haven't seen him, what makes you think he's home?"

"Because," the first mother replied, "we haven't had a letter from him asking for money for more than two weeks, there's more laundry, and besides, the car is gone."

SUNSHINE MAGAZINE

The Indiana Society of  
Professional Land Surveyors

Presents

One Day Seminar on "Rule 13" Property Surveys

Fri. June 5, 1992  
South Bend, IN  
Ramada Inn  
52890 U.S. 31 N.

**Time:** Registration 8:15 am Program 9:00 - 4:30 pm  
**Presenters:** Gary Kent, L.S. - Director, Surveying and Mapping  
Division, Schneider Engineering Corp.  
Wes Day, L.S. - Property Survey Consultant,  
Schneider Engineering Corp.

6 L.S. Professional Development Hours may be obtained by attending!

\* \* \* \* \*

**Reservations:** All fees include lunch. Please fill out this form  
and mail to ISPLS, 55 Monument Circle, Suite 1222, Indianapolis,  
Indiana 46204 Phone 317-687-8859

Name(s): \_\_\_\_\_ Firm Name: \_\_\_\_\_  
\_\_\_\_\_  
Address: \_\_\_\_\_  
City/State/Zip: \_\_\_\_\_ Telephone \_\_\_\_\_

Attendance limited - 50 persons

	No. persons		Sub-total
ISPLS Firm Member	_____	@ \$ 80.00	_____
ISPLS Member	_____	@ \$100.00	_____
Other	_____	@ \$125.00	_____
TOTAL			_____

Payment must accompany reservations. No other discounts apply.

100% refund if ISPLS office is notified by the Friday before the  
reservation or 50% refund if notified later but before the day of  
the reservation.

DRAFT OF SURVEYORS' CREED AND CANONS  
NSPS Ethics Committee

The NSPS Board of Directors, at its July meeting in Denver, charged the NSPS Ethics Committee with the task of drafting a code of ethics for NSPS members. This was necessitated by the ACSM board action revoking the ACSM Code of Ethics in light of the Federal Trade Commission (FTC) investigation.

The NSPS Ethics Committee met October 28 to complete the charge of creating a code of ethics for surveying professionals. The committee agreed to steer clear of a "code", in the strict sense of the word, and attempt to create "canons" that would not be considered a means for possible disciplinary measures against members. These canons will be considered a personal message from NSPS to professional surveyors. It is likely that the document will eventually be printed in a manner suitable for framing.

The committee sought to eliminate the connotation that these canons were absolute rules to guide the professional. In so doing, it substituted the word "should" for "must". The committee was extremely cognizant of FTC's complaints, and used accepted FTC wording where possible. The draft "Surveyors' Creed and Canons" incorporates the existing creed adopted by NSPS years ago.

The ACSM Ad Hoc Code of Ethics Committee, chaired by Jerome Ives, is working on the same charge. It is the hope of all concerned that the findings of the two committees be merged into one document to benefit all ACSM members. In the event that this is not possible, the NSPS document could apply to ACSM surveying members only, if so desired by the boards.

DRAFT OF SURVEYORS' CREED AND CANONS

*This draft reflects the opinions of the members of the NSPS Ethics Committee, not NSPS or the ACSM board.*

As a Professional Surveyor, I dedicate my professional knowledge and skill to the advancement and betterment of human welfare. I pledge:

- To give the utmost of performance;
- To participate in none but honest enterprise;
- To live and work according to the laws of man and the highest standards and professional conduct;
- To place service before profit, the honor and standing of the profession before personal advantage, and the public welfare above all other considerations;
- In humility and with need for Divine Guidance, I make this pledge.

Cannon 1. A Professional Surveyor should refrain from conduct that is detrimental to the public.

Cannon 2. A Professional Surveyor should abide by the rules and regulations pertaining to the practice of land surveying within the licensing jurisdiction.

Cannon 3. A Professional Surveyor should accept assignments only in the areas of professional competence and expertise.

Cannon 4. A Professional Surveyor should, in the performance of a survey, develop and communicate, without bias or personal interest, a professional analysis and opinion.

Cannon 5. A Professional Surveyor should maintain the confidential nature of the surveyor-client relationship.

Cannon 6. A Professional Surveyor should, in promoting a survey practice and soliciting survey assignments, use care to avoid advertising or solicitation that is misleading or otherwise contrary to the public interest.

Cannon 7. A Professional Surveyor should, when dealing with members of other professions, maintain professional integrity.

## CHAPTER NEWS

### St. Joseph Valley Chapter officers for 1992:

Ken Jones, President  
Bob Kirkley, Vice President  
Bob Weaver, Secretary  
Brad Cramer, Treasurer

### Northeast Chapter officers for 1992:

Mike Nagel, President  
Hans Hofer, Vice President  
Joel Hoehn, Secretary-Treasurer

### Northwest Chapter officers for 1992:

Mike Gerberick, President  
Bob Bigelow, President-Elect  
Jerry Byrnes, Secretary-Treasurer  
John Bullock, Director (1 year)  
Van Janovic, Director (2 year)  
Jim Gorski, Director (3 year)

### Hoosier Hills Chapter officers for 1992:

Chuck Coyle, President  
Ken Anderson, Vice President  
Ben Bledsoe, Secretary  
John Kurtz, Treasurer  
E.R. Gray, Director (2 year)  
Mike Arena, Director (2 year)

### Initial Point Chapter officers for 1992:

Tom Boofter, President  
David Blankenkemper, President-Elect  
Frank Ballintyn, Secretary-Treasurer

### Central Indiana Chapter officers for 1992:

Rick Miller, President  
Curt Huff, Vice President  
Bill Luecht, Secretary  
Terry Miller, Treasurer  
Doug Herendeen, Director

### Southwest Chapter officers for 1992:

Matt Wannemuehler, President  
Alvin Paul, Vice President  
Edward Boyd, Secretary-Treasurer  
Gordon Curtis, Director  
Don Biggs, Director

## THE COUNTY SURVEYORS CORNER

by E.R. Gray III, P.L.S.  
President County Surveyors Association

On March 11, 1992 the Indiana County Surveyors Association held their annual meeting in West Lafayette at Purdue University in conjunction with Purdue Road School. An excellent turnout of 54 members and guests were present.

Tippecanoe County Surveyor Michael Spencer was presented the first 1992 President's Award by County Surveyors Association President E.R. Gray, III. This award was conceived by President Gray and the Executive Committee to recognize County Surveyors who are actively working on their corner perpetuation programs. Patrick Cunningham, County Council Officials, Commissioner Nola Gentry, were in attendance for the presentation and were thanked for their help and support to the Corner Perpetuation Program. Congratulations Mike and Tippecanoe County!

Basic information that should be available in a County Surveyors office and where or how to obtain that information was presented by Jeff Souder, Washington County Surveyor. Jeff did a great job on the presentation. Lots of informative information was given for small and large Surveyor offices. This information is available upon request to anyone interested.

Rollyn Blankenkemper, President of Indiana Historic Landmarks Association acknowledged the County Surveyor Association for their contribution of \$100.00 to the I.H.L.A. The current project of I.H.L.A. is the perpetuation of an original witness tree located close to Shoals, Indiana.

Professor John McEntyre expressed his appreciation for the County Surveyors Association contribution of \$100.00 to the John McEntyre Endowment Scholarship Fund.

David Ford, legal counsel for the Indiana Farm Bureau spoke on drainage laws and how the Courts have viewed various drainage problems.

Discussion on possible reconstructing Road School to allow two sessions for County Surveyors was made. No decision has been made at this time.

## COMPLETED CAREERS

### JOHN S. GRIMES, 85 Scholar, Law Professor, Textbook Author Dies

John Samuel Grimes, 85, well-known legal scholar, author, and retired professor of the Indiana University Law School at Indianapolis, died April 5, 1992 in Indianapolis. A 1931 graduate of the Indiana University Law School at Bloomington, he also had a graduate fellowship at the University of Michigan, 1932-33. He was assistant general counsel for the Federal Land Bank of Louisville 1933-42 and general counsel for the Indiana Farm Bureau 1942-48 before becoming a professor in 1948. He taught 30 years, retiring in 1978 as a Distinguished Professor of Jurisprudence.

A respected legal writer and scholar, he wrote such books as Thompson on Real Property; the sixth edition of Indiana Probate Law; the second and third editions of Clark on Surveying and Boundaries, along with other books and articles. He was a nationally recognized archaeologist and historian. He often visited the Yucatan Peninsula in Mexico. Earlier ISPLS members will recall his several conference program discussions dealing with the legal aspects of land surveying particularly in the late 1950s and early 60s.

### STEPHEN W. BURRESS, SR., 82 Former Marion County Surveyor and ISPLS Life Member Dies

Stephen Wint Burres Sr., 82, a former Marion County Surveyor died March 10, 1992 in Indianapolis. He was county surveyor from 1957-1965 having served as deputy county surveyor before that. Afterward, he worked for the land acquisition division of Indiana Highway Dept., retiring in 1973. Mr. Burres was a construction superintendent for Indianapolis Municipal Airport from 1935 to 1940 and served on the Marion County Planning Commission and the Board of Flood Commissioners where he was instrumental in preliminary work on Eagle Creek Dam and Reservoir. As a member of an advisory committee, he helped determine the location of the interstate highway system through the city.

He was a member of Northminster Presbyterian Church, 50-year member of Englewood Masonic Lodge and the Scottish Rite, active in the Boy Scout Band, and life member of ISPLS.

## SURVEYORS HISTORICAL SOCIETY

by Roger Woodfill, Lawrenceburg, IN  
Chapter President S.H.S.

The Indiana Affiliate of the Surveyors Historical Society took part in the Tenth Annual Spring Seminar sponsored by the Association for Living History Farms and Agricultural Museums (ALHFAM) and the Midwest Open-Air Museums Co-ordinating Council (MOMCC). SHS members, Hal Ashton and Brad Rayl presented a hour and half program entitled "History of Surveying in Indiana". The brief history included a display of nineteenth century land surveying equipment, and discussion of how Indian treaties effected the "laying out" of Indiana.

Many of the seminar participants had not realized that the early settlements and farms were required to be surveyed prior to "homesteading". Ashton and Rayl reminded the group that appearance of the surveyor marked the change from wandering Indian tribes and the fur-trapping economy to permanent settlements and the agricultural economy. We think that the historians especially appreciated the precision of the dates shown in the original field notes, and the operators of the historic farms understood the importance of the terrain description in the notes.

The Ashton/Rayl program was a refreshing insight for many of the museum operators. The organization members manage what is called "Living History" museums where museum staff dress as someone would have during the time period that they are depicting. Some of the skills - canning, apron making, etc., had not been of interest to all their customers and the surveyors activity represented a fresh perspective on one part of pioneer life.

Mr. Robert Cottrell of "Conner Prairie" museum met with the Indiana SHS Board of Directors in April as a result of this exposure. The board endorsed a plan to present a program to "Conner Prairie" staff about pioneer surveying. Ashton and Rayl are to chair the liaison work. The initial meeting is scheduled April 27, 1992. Volunteers from the Indianapolis area should contact Ashton or Rayl.

\* \* \* \* \*

Your editor remembers Steve Burres as one of ten enthusiastic interested land surveyors from across the state who attended the first program-planning meeting held May 21, 1952 on the Purdue campus to help plan Indiana's first conference which was held January 14-15, 1953. We are indebted to Steve for his early interest in our profession.

## CALENDAR

**May 19, 1992**  
GPS Surveying, Free 1 day Seminar, Holiday Inn North, Michigan Road, Indpls, presented by Seiler Instrument & Trimble Navigation. Space Limited. For reservations call Bill Powers or Tom Seiler (314) 968-2282 or (800) 444-7952.

**May 20, 1992**  
Central Indiana Chapter ISPLS Meeting

**May 20, 1992**  
GPS Surveying, Free 1 day Seminar, Holiday Inn East, 3100 Dirksen, Springfield, IL, presented by Seiler Instrument & Trimble Navigation. Space Limited. For reservations call Bill Powers or Tom Seiler (314) 968-2282 or (800) 444-7952.

**May 27, 1992**  
Initial Point Chapter Meeting, 6:30 p.m. Social, 7:00 p.m. Meeting Sam's Restaurant & Grill (upstairs), New Albany, Indiana

**June 5, 1992**  
ISPLS Workshop, Rule 13, Ramada Inn, 52890 U.S. 33 North, South Bend, Indiana

**June 9-11, 1992**  
Surveying Automation '92, held in conjunction with A/E/C SYSTEMS '92, Dallas, Texas.

**July 12-16, 1992**  
30th Annual Conference, Urban & Regional Information Systems Association (URISA), Washington D.C.

**July 21, 1992**  
Central Indiana Chapter ISPLS Meeting

**July 29, 1992**  
Initial Point Chapter Meeting, 6:30 p.m. Social, 7:00 p.m. Meeting Sam's Restaurant & Grill (upstairs) New Albany, Indiana.

**August 3-7, 1992**  
ACSM/ASPRS Global Change Conference, Washington D.C.

**October 2, 1992**  
ISPLS Workshop, McCormick's Creek, Topic: Indiana & ALTA/ACSM Land Title Surveys

**September 24, 1992**  
Central Indiana Chapter Meeting

**November 6-12, 1992**  
ACSM/GIS/LIS Fall Convention, San Jose, CA

**November 18, 1992**  
Central Indiana Chapter ISPLS, Meeting

**February 15-18, 1993**  
ACSM/ASPRS Annual Convention, New Orleans, Louisiana.

**March 17-19, 1993**  
Joint Society Convention (ISPLS, ISPE, ASCE, CEI, IEEE), Adams Mark Hotel, Indianapolis

**March 20, 1993**  
ISPLS Workshop, Adams Mark Hotel, Indianapolis, Indiana, (Topic To Be Announced)

## SUSTAINING MEMBERS

**G. LENGEMANN COMPANY**  
2314 NORTH 5TH STREET  
P.O. BOX 496  
NILES, MICHIGAN 49120  
(616) 684-2116

**HARRISON MARKER AND INSTRUMENT COMPANY**  
P.O. BOX 66  
ANOKA, MINNESOTA 55303  
(612) 421-1445

**LEICA INC.**  
111 DEER LAKE ROAD  
DEERFIELD, ILLINOIS 60015  
(800) 645-9190

**SEILER INSTRUMENT & MFG. CO**  
170 EAST KIRKHAM AVE.  
ST. LOUIS, MISSOURI 63119  
(314) 968-2282

**INSTRUMENT SALES & SERVICE OF INDIANA, INC.**  
6330 EAST 75TH STREET  
INDIANAPOLIS, INDIANA 46250  
(317) 849-7090

THANK YOU FOR YOUR CONTINUED SUPPORT!

## CLASSIFIED

### HELP WANTED

Distributor of surveying and construction instruments is opening a new Indianapolis office. We're looking for inside and outside sales persons with knowledge of the surveying and construction industry. Sales background is helpful. Send resume to Mr. Bill Powers, Seiler Instrument, 170 E. Kirkham Avenue, St. Louis, MO 63119

## FIRM MEMBERS

<p><b>M MARBACH &amp; BRADY B</b> LAND SURVEYING, INC. 88808 Jay Dee Street • Elkhart, Indiana 46514</p> <p>Christian F. Marbach, R.L.S. President (819) 293-3611</p>	<p><b>VASCO KIRBY, L.S.</b> KIRBY BROTHERS SURVEYING CO. 5525 GEORGETOWN ROAD SUITE D INDIANAPOLIS, INDIANA 46254</p> <p>TELEPHONE 298-7875 FAX 298-7885</p> <p>13171872-8400 JOE M BLEVINS, L.S. Vice President</p>	<p><b>S SCHNEIDER ENGINEERING CORPORATION</b> Civil Engineering - Land Surveying JOHN V. SCHNEIDER, P.E.L.S. PRESIDENT</p> <p>3020 N. Post Road P.O. Box 26068 Indianapolis, Indiana 46226-0068 OFFICE: 317-898 8282</p>
<p><b>VESTER &amp; ASSOCIATES, INC.</b> SURVEYING &amp; SUBDIVISION DESIGN</p> <p><b>PATRICK N. CUNNINGHAM, R.L.S.</b> PRESIDENT</p> <p>TELEPHONE (317) 742-8479 309 COLUMBIA ST. SUITE 101 LAFAYETTE, INDIANA 47901</p>	<p><b>FINK ROBERTS &amp; PETRIE, INC.</b> <b>FRP</b> CONSULTING ENGINEERS</p> <p>3307 WEST 96TH STREET INDIANAPOLIS INDIANA 46268</p> <p>STRUCTURAL CIVIL SURVEYING SWAMP SITE DEVELOPMENT STUDIES</p>	<p><b>ANDERSON &amp; ASSOCIATES</b> Carl M. Anderson, Founder</p> <p>222 E. Main St. P.O. Box 585 Lafayette, IN 46052</p> <p>Specialists in Land Development CARY B. DODGE, R.L.S. Phones (317) 482-5141 (317) 873-2515</p>
<p>317-653-8714 317-653-0710</p> <p><b>ALAN STANLEY &amp; ASSOCIATES, INC.</b> ENGINEERING AND SURVEYING</p> <p>124 E. WALNUT STREET GREENCASTLE, INDIANA 46135 ALAN STANLEY PRESIDENT</p>	<p>Telephone 882-9301</p> <p><b>SITE LINE, INC.</b> Land Surveying and Civil Engineering</p> <p>John H. Sites L.S. 461 West Main, P.O. Box 602 Greenwood, IN 46142</p>	<p><b>LSC LAND SURVEYING AND CONSULTING, INCORPORATED</b></p> <p>LESLIE A. WEBER INDIANA REGISTERED LAND SURVEYOR</p> <p>8111 Llama Rd. Fort Wayne, IN 46818 Office: 219-489-1528 Mobile: 433-0629</p>
<p><b>RLAW</b> CONSULTING ENGINEERS ARCHITECTS INDIANAPOLIS &amp; SOUTH BEND</p> <p>J EDWARD DOYLE, PE PRESIDENT</p> <p>REID QUEB: ALLISON WILCOX &amp; ASSOCIATES INC. 4755 KINGSWAY DRIVE • SUITE 400 • INDIANAPOLIS IN 46205 317-255-6060</p>	<p><b>AMERICAN CONSULTING ENGINEERS, INC.</b></p> <p>• CIVIL • ENVIRONMENTAL • SURVEYING • STRUCTURAL • ARCHITECTURAL • PLANNING</p> <p>4165 MILLERSVILLE ROAD INDIANAPOLIS, INDIANA 46205 OFF. (317) 547-5580 FAX (317) 543-0270</p>	<p>Land Surveyors • Consulting Engineers</p> <p><b>United Surveying, Inc.</b> 5332 N. Temple Ave. Indianapolis, IN 46220</p> <p>DANIEL R. WOO, Pres. Bus.: 317/253-4996 Registered Land Surveyor Res.: 317/894-8172</p>
<p><b>H Holloway Land Surveying</b></p> <p>ROSS O. HOLLOWAY REGISTERED LAND SURVEYOR</p> <p>410 N. Monroe, Suite 10 Pebbles Plaza P.O. Box 234 Mooresville, IN 46158 Telephone 317-831-7918</p>	<p>Boundary Surveys Subdivision Design Plat Plans Construction Surveys</p> <p><b>JOHN H. STEPHENS, R.L.S., Inc.</b></p> <p>134 S. Wabash St. Wabash, IN 46792 Bus 563-4467 Home 563-6080</p>	<p>Registered Surveyor Indiana - Illinois - Wisconsin (317) 828-2354</p> <p><b>E. J. HUTSON AND ASSOCIATES</b> PROFESSIONAL LAND SURVEYORS LAND SURVEYS-CONSTRUCTION LAYOUT</p> <p>801 Chestnut Blvd. Charleston, Indiana 46304 EDWARD J. HUTSON, R.L.S.</p>
<p><b>R.W. ARMSTRONG</b> APPROX. DEVELOPMENT</p> <p>MERSHEL W. BANYANT, L.S. Land Surveyor</p> <p>7801 S. Pennsylvania Street Indianapolis Indiana 46275 (317) 786-0461</p>	<p>LAND AND PROJECT SURVEYORS</p> <p><b>ARTHUR F. HAUFLE, INC.</b> (FOUNDED 1895)</p> <p>THE MAJESTIC BUILDING SUITE 302 47 S. PENNSYLVANIA ST. INDIANAPOLIS IN 46204 TELE. (317) 632-5003</p>	<p><b>CHET SKWARCAN</b> Professional Engineer Land Surveyor</p> <p><b>W JOHN W. WEAVER &amp; ASSOC., INC.</b> CONSULTING ENGINEERS LAND SURVEYORS</p> <p>801 W. Bardsley Ave. Elkhart, IN 46514 (219) 294-1830 Fax (219) 293-9366</p>
<p>Engineering Digital Mapping Surveying Landscape Architecture</p> <p><b>M&amp;E Corporation</b></p> <p>541 North Meridian Street Indianapolis, IN 46204 1061 317 634 1000 317 634 2576 FAX</p> <p>Set C. Baker, P.E., L.S. President</p>	<p><b>PTGR</b> ENGINEERS-LAND SURVEYORS</p> <p>ORDELL L. GERTSMEER Indiana Professional Engineer #9511 Indiana Land Surveyor #9970</p> <p>158 NAPOLEON WILPARAISO IN 46383 219-462-1156</p>	<p><b>DONOVAN ENGINEERING</b> 2030 INWOOD DRIVE EXECUTIVE PARK FORT WAYNE, IN 46815</p> <p>JOHN R. DONOVAN P.E. &amp; P.L.S. OFFICE 424-7418 HOME 483-3312</p>
<p><b>PAUL I. CRIPE, INC.</b></p> <p>James E. Dankert, PE., L.S. Partner</p> <p>7172 Graham Road, Indianapolis, Indiana 46250 (317) 842-6777 Land Development Engineers Land Surveyors Architects Land Planners</p>	<p><b>WEIHE ENGINEERS INC.</b></p> <p>10505 N. College Indianapolis IN 46280 (317) 846-6611</p> <p>ALLAN H. WEIHE, P.E., L.S. PRESIDENT</p> <p>CIVIL ENGINEERS LAND SURVEYORS LAND PLANNERS</p>	<p><b>STOEPPELWEIHER &amp; ASSOCIATES, INC.</b></p> <p>R.M. Stoepelweher, PE, PLS President</p> <p>(317) 849-5935</p> <p>CONSULTING ENGINEERS-LAND SURVEYORS 9940 Alcornville Dr. P.O. Box 509967 Indianapolis, IN 46259 1-800-728-4917 FAX (317) 849-5947</p>

## THE HOOSIER SURVEYOR

Indiana Society of Professional Land Surveyors, Inc.  
55 Monument Circle, Suite 1222  
Indianapolis, Indiana 46204

Bulk Rate  
U. S. Postage  
PAID  
Indianapolis, Ind.  
Permit No. 4056



HOW CAN I BUY MORE  
MARKERS ON MY BUDGET?

Harrison's SLIMLINE markers have all of the permanence features that have made Harrison markers number one in America, yet they are light and economical. Some cost-efficient surveyors have chosen SLIMLINE markers for their secondary witness corners, and others have gone to the small Harrison TOPPERS pounded onto a 1" round steel bar for less important points. *Harrison can fit your budget.*

# THE ANSWER IS Harrison!

For Information WRITE  
or PHONE

**HARRISON**  
**MARKER CO.**

Box 66, Anoka, MN 55303  
(612) 421-1445